

# FR 30 SM 45



## WALK BEHIND SCRUBBER DRYERS FR 30 SERIES - MANUAL

FR 30 SM 45 TOUCH is the new born in the FR 30 TOUCH family. Simply Manual: a system of solutions which is able to combine the best scrubbing and drying performance with an extreme ease of use: the result is a perfect mix between practicality and cost-effectiveness which guarantees the best operational performance. The new design, makes the machine a masterpiece of aesthetic and ergonomics. Then 30 liters of tank capacity, an high manoeuvrability and above all a complete set of integrated solutions making FR 30 suitable for any environment and surface: - Thanks to the new sensor TOUCH SYSTEM, FR 30 TOUCH can be moved and controlled only using a thumb: intuitive, user friendly and reliable. - Compact squeegee: large only 65 cm, and adjustable, for excellent drying results. - A complete set of filters to protect the main components and give to FR 30 the max reliability. - Performance: high productivity, remarkable running time (up to 1 hour and a half), top cleaning results. FR 30 SM 45 TOUCH is available in two versions: basic and full package (standard on board charger + batteries).



Control panel

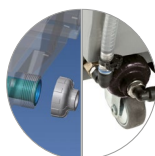

"Built in" solution tank filter



Adjustable and compact squeegee



Debris tray + recovery tank filter



Tiltable recovery tank

### PRODUCT IDENTIFICATION

TYPE	REF. NO.	PIECES/PALLET
FR 30 SM 45 TOUCH	10.4187.00	1
FR 30 SM 45 BC TOUCH	13.4187.00	1

### TECHNICAL DATA

#### FEATURES

Cleaning width	mm	430
Squeegee width	mm	650
Productivity (theoretical - practical)	m <sup>2</sup> /h	1720 - 1030
Power supply		Battery 24V
Installed power	W	600
Advancement		Manual
IP code		IPX3

#### BATTERIES

Type	Gel battery set (2 pcs) 12V 50Ah (*)	
Running time	h - min	1 h and 30 min
Battery compartment dimensions x No	mm x No	340x340x240 X 1

#### BRUSHES

Pad diameter x No	mm - inch x No	430 - 17" x 1
Motor rating x No	W x No	200 x 1
Motor speed	rpm	120
Down pressure - Contact pressure	Kg - g/cm <sup>2</sup>	18 - 17,4

#### TRACTION

Motor rating	W	---
Driving speed	Km/h	4
Hill climbing ability (full load)	%	2

#### VACUUM

Motor rating	W	400
Vacuum	mbar - mmH <sub>2</sub> O	1189
Airflow rating	l/s	28
Noise level	dB(A)	64

#### TANK

Type	Double tank	
Cleaning solution tank	l	30
Recovery tank	l	33
Weight (empty/with batteries)	Kg	66 /104
Dimensions	mm	1210x560x1020

### STANDARD ACCESSORIES

TYPE	REF. NO.
Solution tank filling hose	30.0024.00
17" Polypropylene brush ø 0.7	40.0002.00
On board charger 24V 5A (*)	22.0630.00
Gel battery set (2 pcs) 12V 50Ah (*)	18.0026.00
Front + rear natural rubber blades	96.0159.00

### OPTIONAL ACCESSORIES

TYPE	REF. NO.
17" Polypropylene brush ø 0.9	40.0102.00
17" Tynex brush ø 1.2 grit 80	40.0202.00
Pad holder 420 mm (for 17" pad)	40.1007.00
Set front + rear polyurethane squeegee blades	96.0011.00
Extra weight for squeegee (1x700 g) (**)	96.0171.00

(\*) For BC version

(\*\*) You can use maximum one weight